

Welcome to the Phil and Jennie Gaglardi Surgical Centre at Vancouver General Hospital

On the day of your surgery:

- Hospital entrances are located on **W. 12th Avenue** and **W. 10th Avenue**.
- Pay parking is available in the **W. 12th Avenue parkade** and in the **Diamond Health Care Centre parkade**. Metered street parking is also available near the hospital.

If your surgery is scheduled Monday-Friday:

From W. 12th Avenue:

- Please arrive at the **Jim Pattison Pavilion Main Entrance (899 W. 12th Avenue)** at your check-in time (see Level 1 map).
- Walk to **Admitting**, located behind the **Information Desk** at the main entrance of the **Jim Pattison Pavilion**.

From W. 10th Avenue:

- Enter through the **Non-Emergency Entrance (950 W. 10th Avenue)** west of the **Emergency Department** prior to your check-in time (see Level G map).
- Follow the hallway past the **Diagnostic Treatment Unit** and turn right at the fork; turn left past the **Cardiac Intensive Care Unit** and follow the hallway to the next fork; turn left and continue on to the **elevators** at the right.
- Take the elevator to **Level 1**; follow the sign to the **Jim Pattison Pavilion Main Entrance** and head past the **Bett Lauridsen Commuter Centre** towards the **Information Desk**; turn left to check in at **Admitting**.

- After checking in, turn right, down the hallway behind the **Information Desk** towards the **CIBC Centre for Patients & Families** and **Paetzold Auditorium**. Follow this hallway until you reach **elevators 2, 3 & 4**.
- Take the elevators up to **Level 2 or 3**, as directed by Admitting.
- Please follow the map provided at Admitting to find your way to the **Perioperative Care Centre (Level 2)** or the **Registration Desk (Level 3)**.



If your surgery is scheduled on a weekend:

- Please arrive at the **Emergency Department (920 W. 10th Avenue)** and walk to **Emergency Admitting**.
- After checking in, follow the hallway; turn left and continue on to the elevators.
- Take the elevators up to **Level 2 or 3**, as directed by Admitting.
- Please follow the map provided at Admitting to find your way to the **Perioperative Care Centre (Level 2)** or the **Registration Desk (Level 3)**.

During surgery:

- Your friends, family, or support persons may wait during your surgery in the **Surgical Family Waiting Room**, located on Level 2 of the Jim Pattison Pavilion, inside the **Sassafras cafeteria** (see Level 2 map).
- Patient tracking boards in the **Surgical Family Waiting Room** provide real-time updates on where patients are in their surgical journey.
- Food and beverages are available for purchase in the **cafeteria** on Level 2; in **Café Ami**, near the main entrance of the Jim Pattison Pavilion (see Level 1 map); and in the Gordon and Leslie Diamond Health Care Centre (see the VGH campus map).

After surgery:

Family may have the opportunity to visit for a few minutes in the **Post-Anesthetic Care Unit (PACU)** or **Perioperative Care Unit (PCU)**. If this is possible, your family member/support person will see a notice on the **patient tracking board**.

If this is not possible, they will be able to see you in **your room** on an inpatient unit.



Vancouver General Hospital Campus Map

The Phil and Jennie Gagliardi Surgical Centre at VGH is located in the Jim Pattison Pavilion, located at 899 West 12th Avenue.

Parking is available in the **West 12th Avenue parkade** and in the **Gordon and Leslie Diamond Health Care Centre parkade**. Street parking is also available near the hospital.

Questions?

If you have any questions or need assistance finding your way, please ask **Information Desk** volunteers when you arrive, or staff at one of the **Surgical Registration Desks** located on Level 2 and 3 of the Jim Pattison Pavilion (see interior maps on the following pages for more details).



- - - Directions for Monday-Friday surgical patients
- Directions for weekend surgical patients

Jim Pattison Pavilion
North Entrance
910 W. 10TH Ave.

Level G



- ↑ Main Entrance
- ♀ Women's Washroom
- ♂ Men's Washroom
- ♿ Accessible Washroom
- ♂♀ All Gender Washroom
- ❓ Information Desk
- ♿ Diaper Change
- 🚶 Stairs
- 🏠 Elevators
- ☎ Telephone
- 💰 Bank Machine
- 📠 TTY

JIM PATTISON PAVILION NORTH

EMERGENCY DEPARTMENT

Elevator: 2, 3, 4
Stairwell: 4

To Blusson Spinal Cord Centre, X-Ray, Segal Family Health Centre, Heather Pavilion (Medical Records)

JIM PATTISON PAVILION SOUTH

BLACKMORE PAVILION

899 W. 12TH Ave.

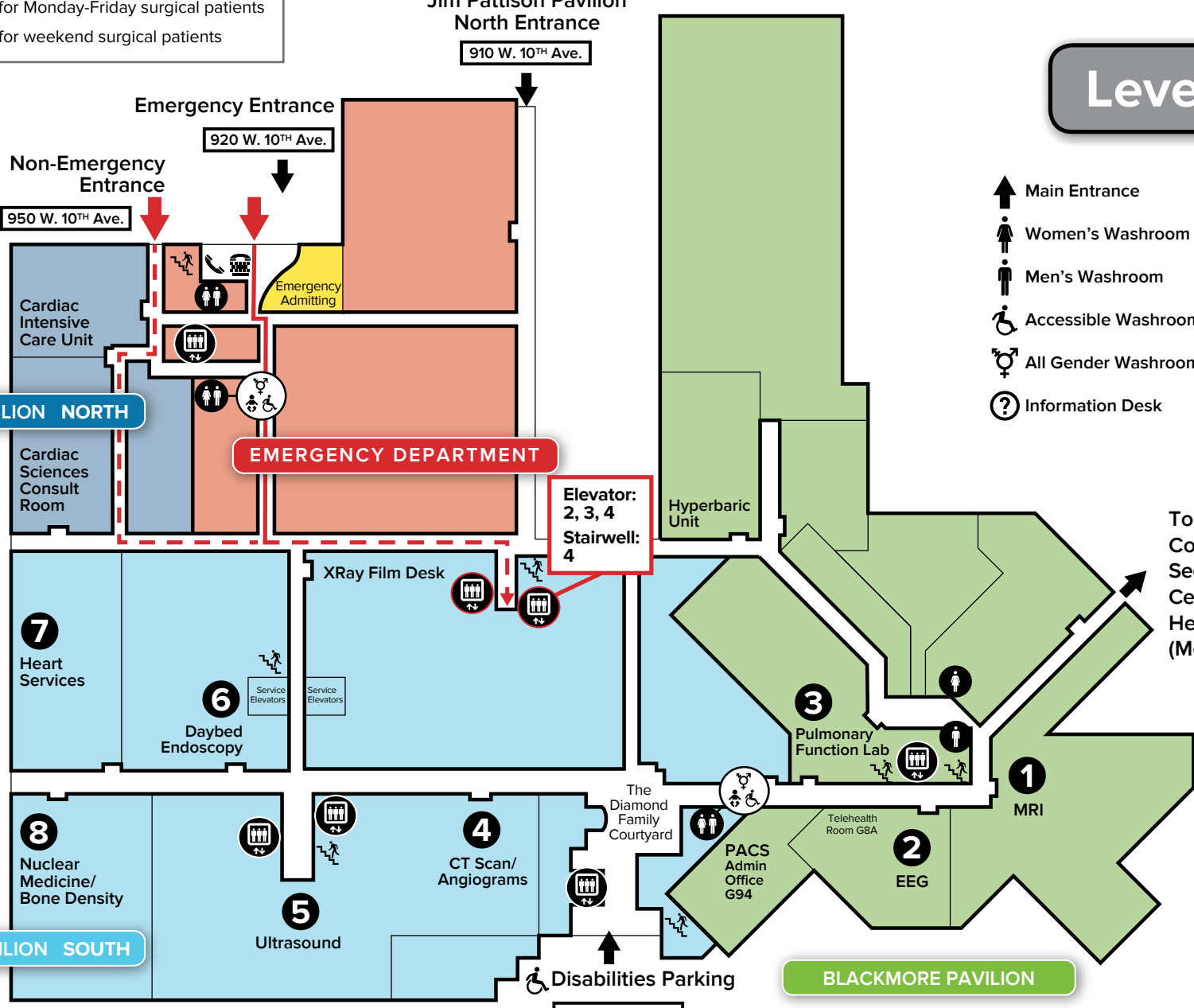



Level 1

- Main Entrance
- Women's Washroom
- Men's Washroom
- Accessible Washroom
- All Gender Washroom
- Information Desk
- Diaper Change
- Stairs
- Elevators
- Telephone
- Bank Machine
- TTY

JIM PATTISON PAVILION NORTH

JIM PATTISON PAVILION SOUTH

BLACKMORE PAVILION

Laurel Street Entrance
To Diamond Centre & Parkade
2700 LAUREL St.

Paetzold Auditorium & Multipurpose Room
Elevator: 2, 3, 4
Stairwell: 4

Bett Lauridsen
Commuter Centre

1865
Centre for Patients
& Families
Admitting

Hemodialysis Unit

Medical Infusion Clinic

Independent
Dialysis Unit

Rehab Services

Gift Shop

Cafe Ami

Information Desk

A Sacred Space

Overpass
to Parkade

Main Entrance
Jim Pattison Pavilion
899 W. 12TH Ave.

Leon Judah Blackmore
Pavilion Entrance
Staff Shuttle Pick Up

855 W. 12TH Ave.

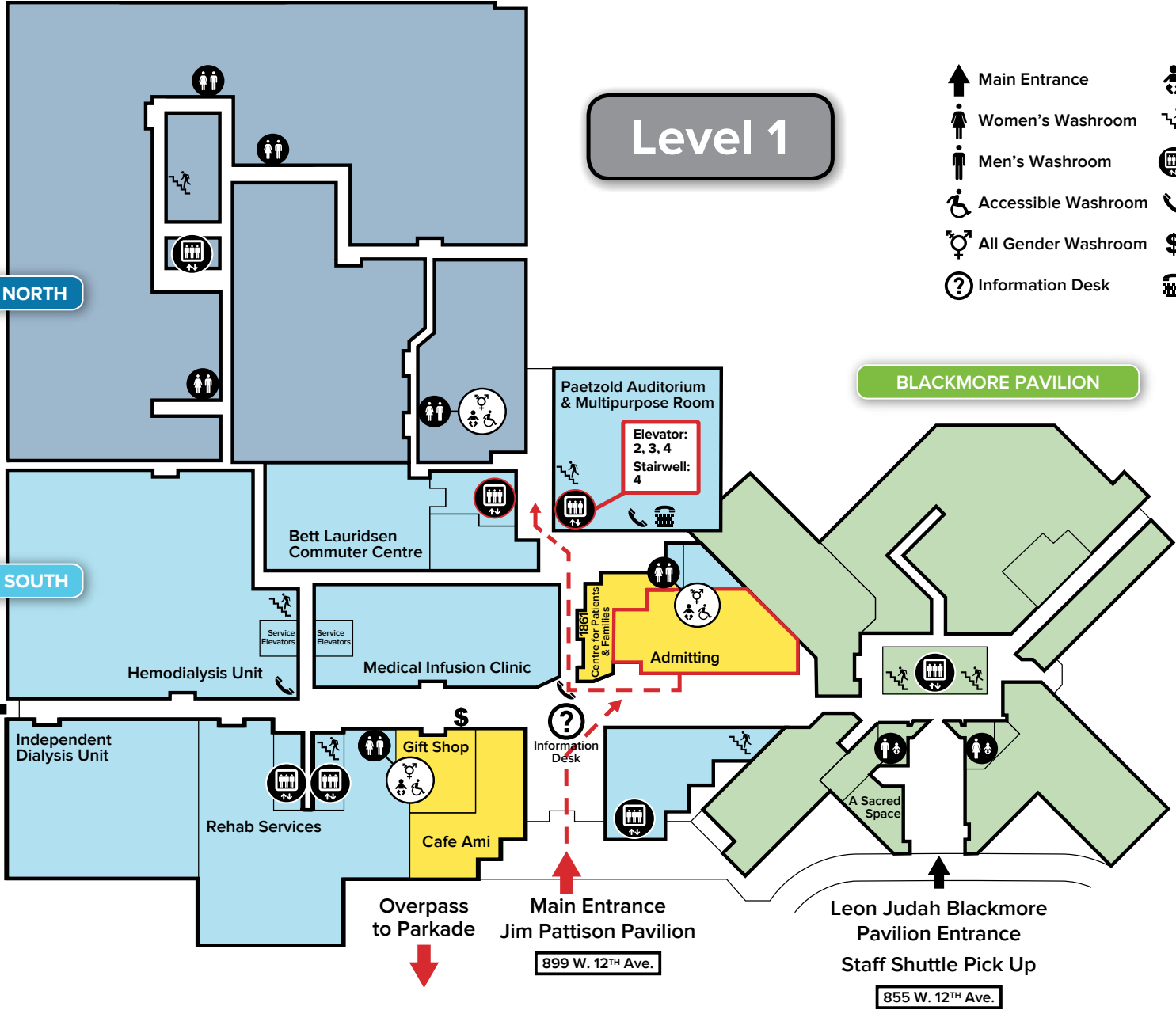

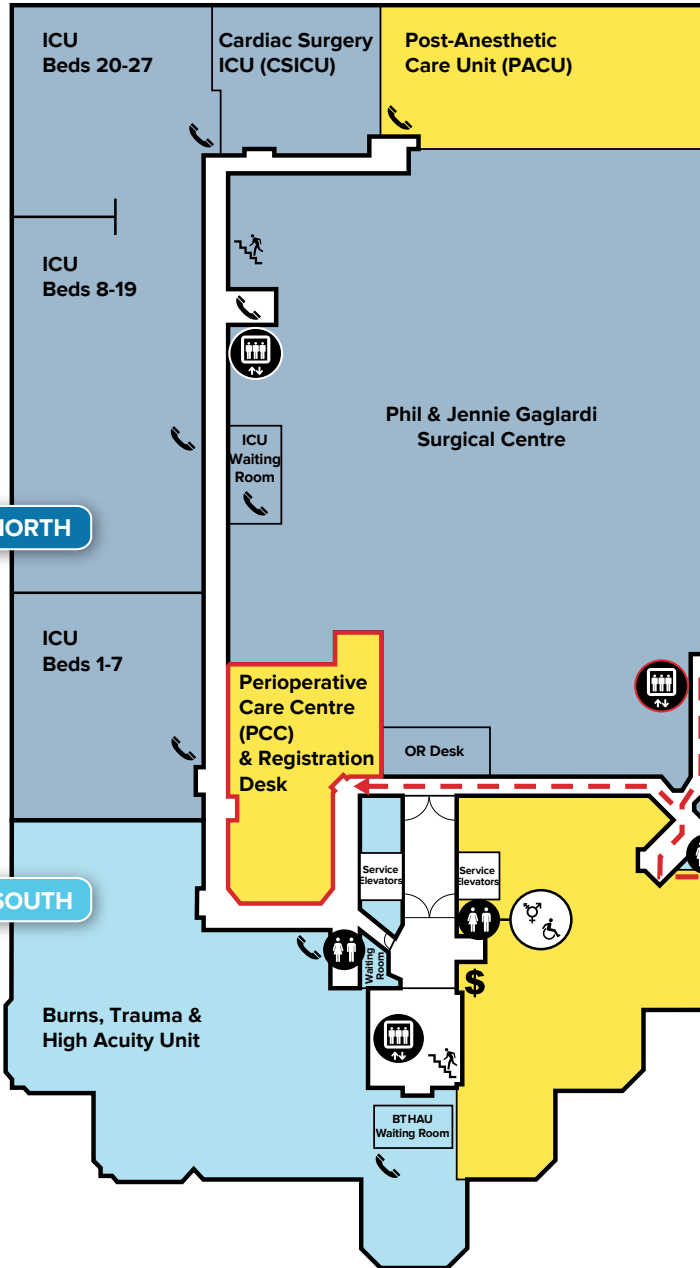

Level 2

JIM PATTISON PAVILION NORTH

JIM PATTISON PAVILION SOUTH

BLACKMORE PAVILION

- Women's Washroom
- Men's Washroom
- Accessible Washroom
- All Gender Washroom
- Stairs
- Elevators
- Telephone
- Bank Machine

Elevator: 2, 3, 4
Stairwell: 4



Level 3

- Women's Washroom
- Men's Washroom
- Accessible Washroom
- All Gender Washroom
- Stairs
- Elevators
- Telephone
- Bank Machine

JIM PATTISON PAVILION NORTH

JIM PATTISON PAVILION SOUTH

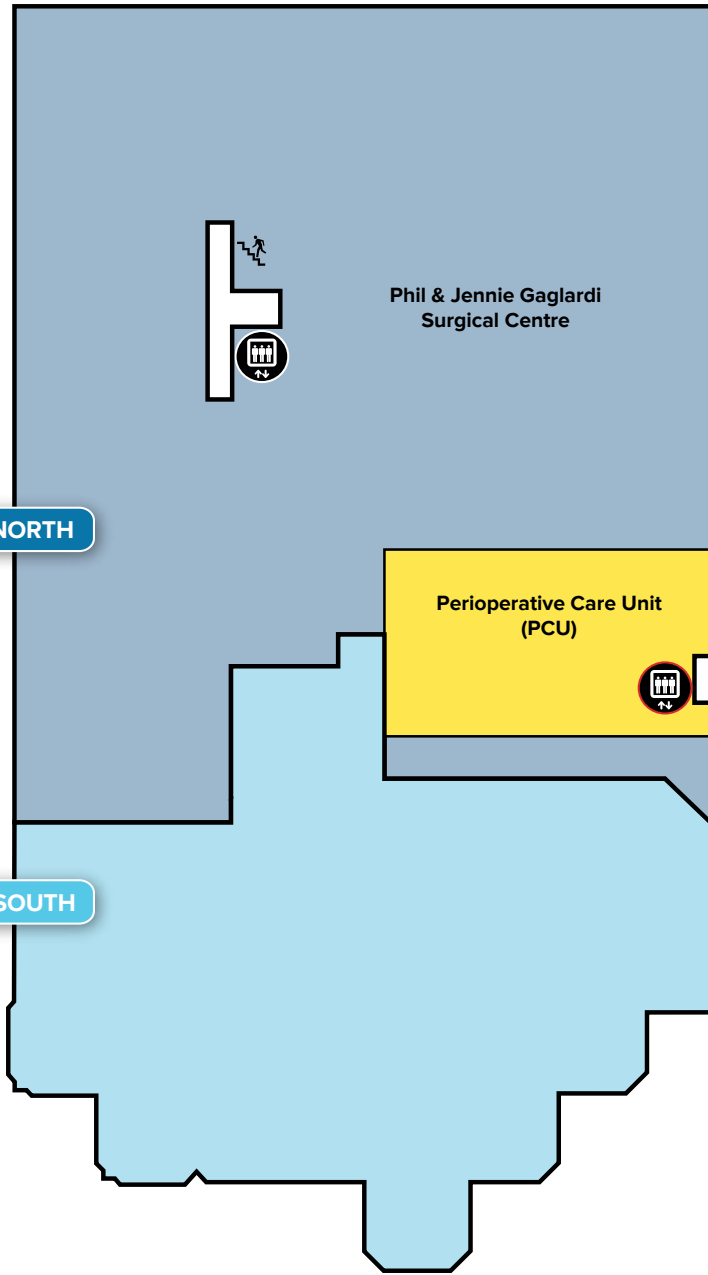

Phil & Jennie Gagliardi Surgical Centre

Perioperative Care Unit (PCU)

Registration & Family Waiting

Elevator: 2, 3, 4
Stairwell: 4

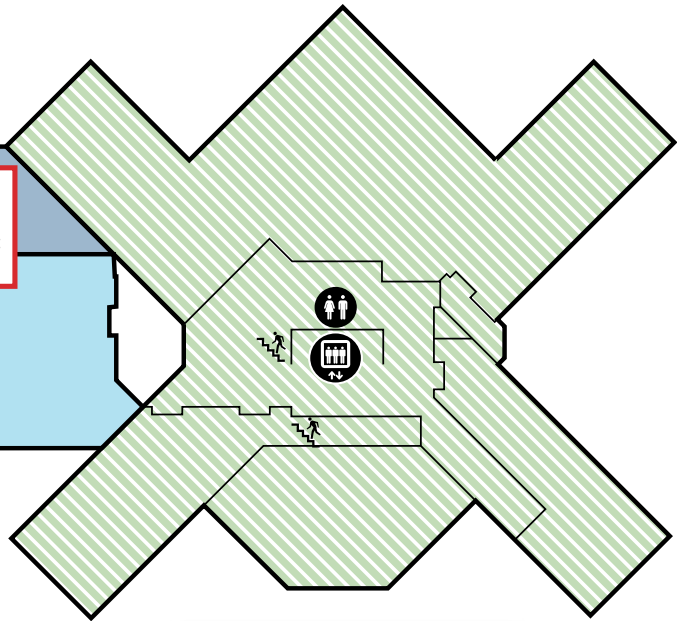

BLACKMORE PAVILION